

LOWER BUCKS COUNTY JOINT MUNICIPAL AUTHORITY SANITARY SEWER MANHOLE REQUIREMENTS

1. Structures / materials shall not be located within a 5' radius of manhole.
2. 24-hour unimpeded access to manhole is required with the entire 5' radius being clear and accessible. Unlimited height restriction.
3. Fence shall not be located directly over or within 5' radius of manhole unless the following requirements are met:

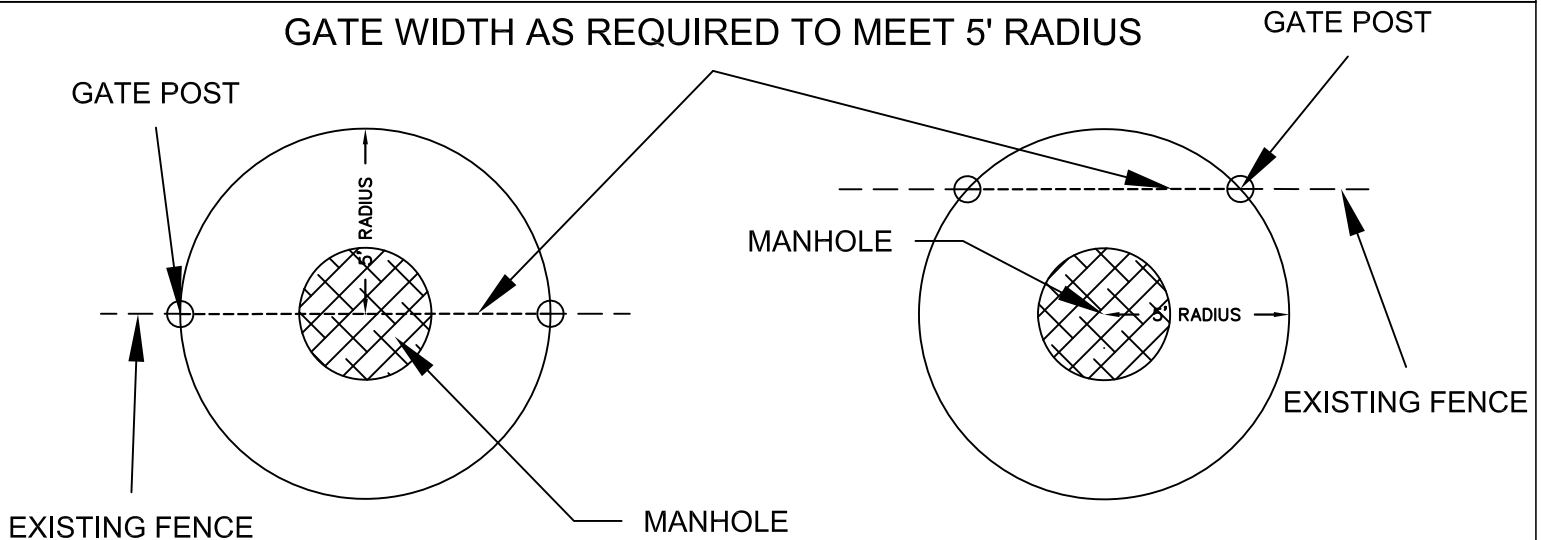

EXAMPLES TO MEET MANHOLE REQUIREMENTS

GATE WIDTH AS NEEDED WITH HINGES AND LATCH MUST BE CENTERED OVER MANHOLE

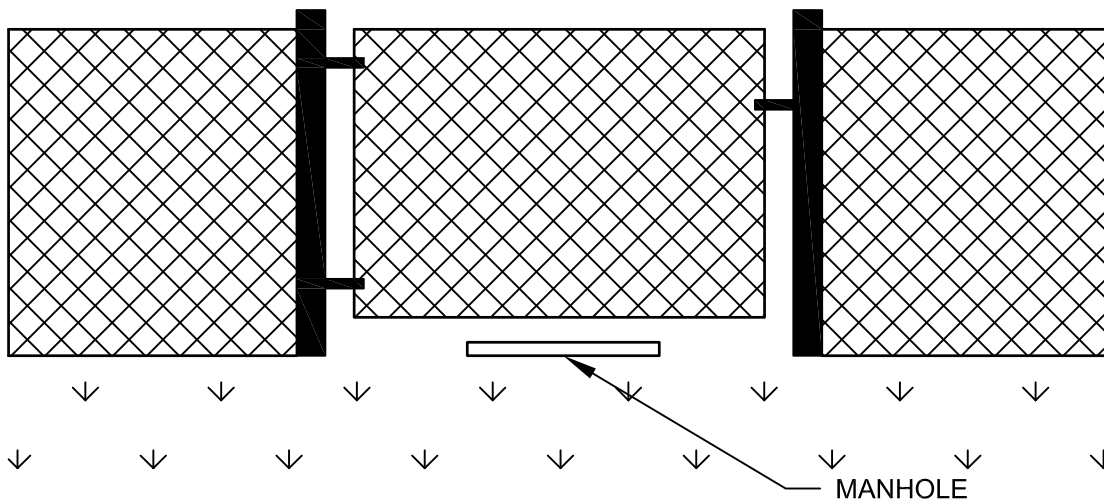

NOTES:

1. Permits shall be obtained prior to construction of fence.
2. Requirements cover all types of fencing.
3. Chainlink style used for illustration purposes.
4. Gate must swing freely over the manhole.
5. If homeowner desires a lock, one may be obtained at 7900 Bristol Pike, Levittown PA 19057 during normal business hours.
6. Placement of fence shall not "box out" manhole or make it inaccessible.